

Section DD

Sections CC & DD

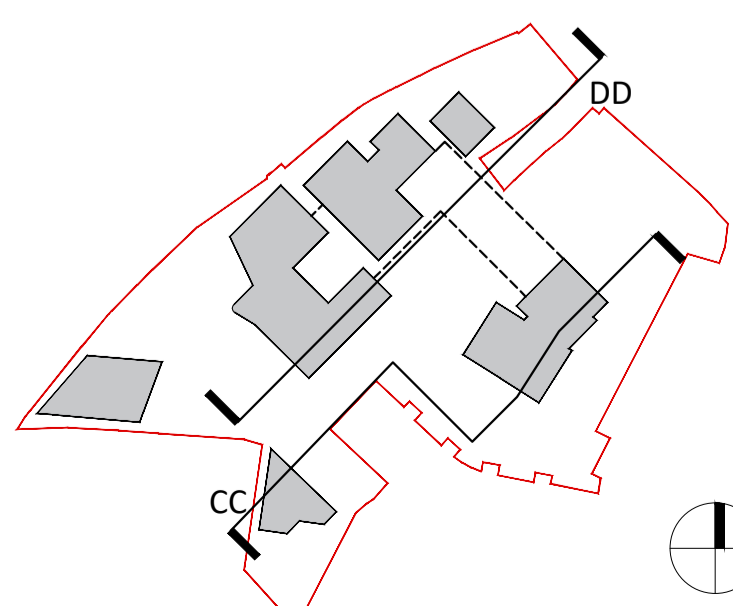

Revision Description	Date	Rev. No.	Issued by
Issued for SHD submission	02-09-2019	6	SK
Issued for review	16-08-2019	5	SK
Issued for review	29-07-2019	4	SK
Issued for submission	05-04-2019	3	AB
Issued for comment	01-04-2019	2	AB
First Issue	20-03-2019	1	AB

Figured dimensions only to be used. This drawing is copyright of O'Mahony Pike Architects Ltd. All information is shared as per approved use in accordance with BS1192(2007) + A2(2016), Table 5; Standard Codes for Suitability of Models and Documents. If 'Information Approval Check' is empty, this information has been shared at SO - WIP.

**omahony pike**

architecture | urban design    Dublin    Cork  
 email: info@omahonypike.com    The Chapel    26 South Mall  
 tel: +353 1 202 7400    Mount St. Anne's    Cork City  
 fax: +353 1 283 0822    Milltown, Dublin 6    Co. Cork  
 www.omahonypike.com    D06 XNS2 Ireland    T12 R2RV Ireland

**Project:** The Grange KW  
**Location:** Dublin  
**Client:** KW PRS ICAV Acting For And On Behalf Of its Sub-fund KW PRS Fund 10

**Project No.:** 1818    **Scale @ A1:** 1:200  
**Project Lead:** CK    **Date Printed:** 02-09-2019  
**Drawn By:** SV    **Current Rev.:** 6  
**Model No.:** 1818-OMP-00-ZZ-DR-A-XX-31000  
**Purpose:** S4

**Drawing Title:** Sections CC& DD  
**Drawing No.:** 1818-OMP-00-ZZ-DR-A-XX-31001

Suitability - Checked By: SK